



St Johns Building  
Marsham Street SW1P

**M**askells

---

A 2 bedroom flat, with a balcony, on the 5th floor of a highly regarded modern development offering 24/7 concierge, gym and swimming pool.



### Accommodation and Amenities

- CONCIERGE
- GYM AND POOL
- EXCELLENT LOCATION
- MODERN DEVELOPMENT





---

St John's Building is a sought-after development in Westminster, close to a vast array of world class amenities and transport links.

The apartment itself offers a lateral arrangement. Towards the front is an excellent reception room, some 28 ft in width with windows on 3 sides, flooding the room with natural light. There is a separate kitchen with modern appliances. There are two double bedrooms, both with en-suite bathrooms and built-in storage. One bedroom also benefits from a balcony. The flat is completed by a guest cloakroom and a storage area. The flat is very well presented.





## APPROXIMATE FLOOR AREA

120.52 sq m / 1,297 sq ft

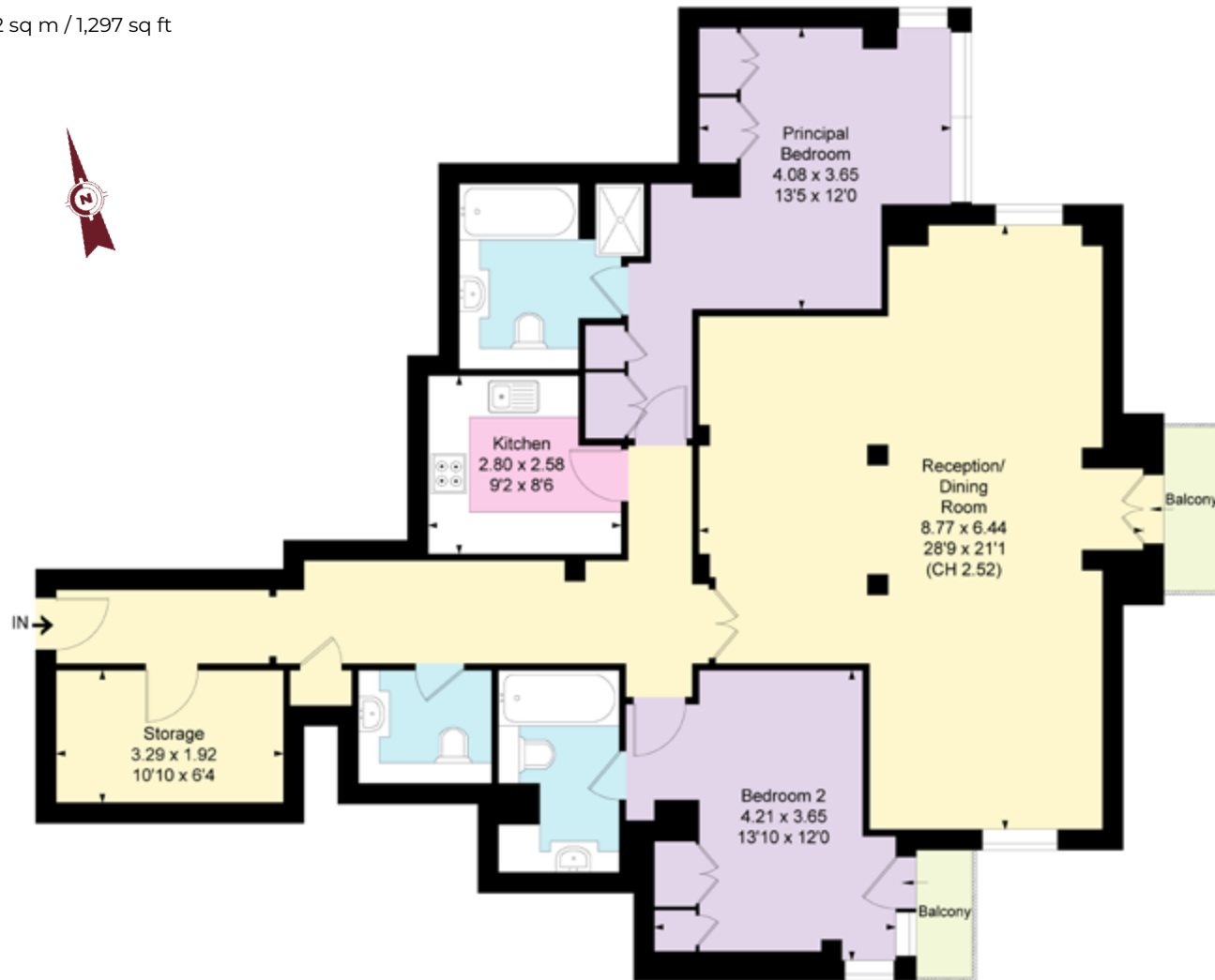

Fifth Floor

## TERMS

**Asking Price** £1,275,000

**Tenure** Leasehold, expires 24th June 2997

**Service Charge** Approx £16,285 per annum

**Ground Rent** £500 per annum

**EPC** D

**Council Tax Band** G

**Local Authority** City of Westminster

*Let's talk Mortgages*

Maskells has partnered with CBM Financial, an independent mortgage broker, directly authorised with specialist knowledge and whole of market access.

**CLICK HERE**

[mortgages@maskells.com](mailto:mortgages@maskells.com)

Your home may be repossessed if you do not keep up repayments on your mortgage



@maskellsea

# Maskells

71 Walton Street, London SW3 2HT

Tel: 0207 581 2216

[sales@maskells.com](mailto:sales@maskells.com)

[lettings@maskells.com](mailto:lettings@maskells.com)

[maskells.com](http://maskells.com)